

ADJUSTMENTS

Always ensure that the basic settings made by Öhlins are intact.

1 Spring Preload

Turn the knob on the hydraulic preload adjuster to set the spring preload. Turn clockwise to increase the preload, turn counter clockwise to decrease.

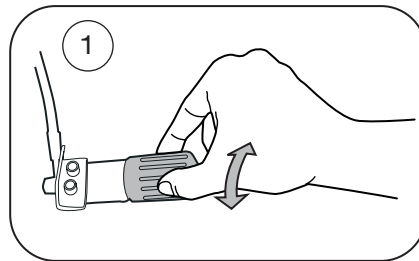

2 Rebound

Turn the wheel on the piston shaft above the end eye/bracket. Turn clockwise to increase damping, turn counter clockwise to decrease.

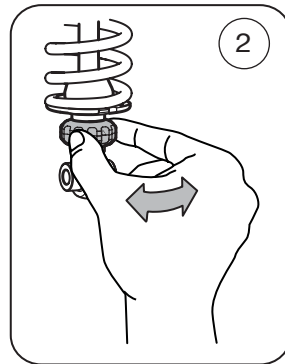

Mounting Instruction

WITH SET-UP DATA

Shock absorber SU728
Suzuki GSF650 Bandit

Before installing this shock absorber, check the contents of the kit listed below. If anything is missing, please contact your nearest Öhlins dealer.

Kit Contents:

	Art. No.	Pcs
Shock absorber	SU728	1
Tie-rop	00231-01	2
Sticker "ÖHLINS"	00192-01	2
Sticker "Memo notes"	01180-01	1
Owners manual		1

Set-up data:

Shock absorber length	319,5 mm
Stroke	63,5 mm
Spring preload	16 mm
Spring free length	180 mm, 130 N/mm
Rebound adjustment	12 clicks

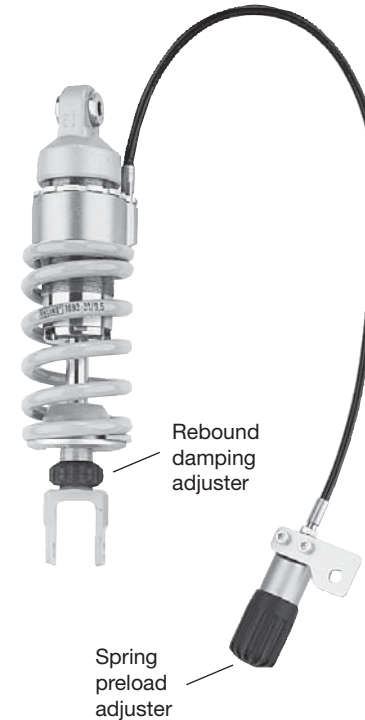

During storage and transportation, especially at high ambient temperature, some of the oil and grease used for assembling may leak and stain the packaging. This is in no way detrimental to the product, wipe off the excessive oil/grease with a cloth.

© Öhlins Racing AB. All rights reserved. Any reprinting or unauthorized use without the written permission of Öhlins Racing AB is prohibited. Printed in Sweden.



Mounting Instruction SU728 2007-10-17.
These instructions and other documents can be downloaded from www.ohlins.com

Öhlins Racing AB, Box 722, S-194 27 Upplands Väsby, SWEDEN. Phone +46 8 590 025 00 Fax +46 8 590 025 80 www.ohlins.com

Before installing this product, read the Öhlins Owner's Manual!



HOW TO INSTALL

⚠ WARNING!

It is advisable to have an Öhlins dealer to install the shock absorber. Refer to your vehicle service manual when installing this product.

1. Put the motorcycle on a workstand and raise it so that the rear wheel barely touches the ground.

⚠ WARNING!

Make sure the vehicle is securely supported so that it will not tip.

2. Loosen the right foot pin and let it hang loose.

3. Remove the **original shock absorber**:

Remove the lower attachment of the shock absorber (A), the front attachment of the triangle link (B) then the upper attachment of the brake rod (C).

4. Remove the whole triangle link and the brake rod.

5. Remove the cover on the left side of the vehicle.

6. Loosen the upper attachment and remove the original shock absorber downwards.

NOTE!

Before installing the Öhlins shock absorber:

- Clean the vehicle thoroughly
- Adjust the length of the shock absorber (check the headlight angle after adjusting the length!)

7. Install the **ÖHLINS shock absorber**:

Install the ÖHLINS shock absorber with the gas nipple pointing towards the rear (do not tighten yet) by reinstall the triangle link (C, B and A). Let the hydraulic spring preload adjuster hang out on the right side of the vehicle.

NOTE!

Lower the motorcycle so that the shock absorber is slightly compressed, before tightening the screws.

9. Install the **ÖHLINS hydraulic spring preload adjuster** with bracket on the inside of the right rear footrest bracket and the silencer bracket. Use the original bolt and nut. Fix the adjuster with provided tie-raps.

⚠ WARNING!

Make sure that the hydraulic preload adjuster hose runs in soft bends. Also check that it does not come in contact with the exhaust pipe or any sharp edges.

11. Reinstall all removed parts in the same way as they were before installation of the ÖHLINS shock absorber.

NOTE!

Make sure that all screws are tightened to the correct torque and that nothing fouls or restricts movement of the shock absorber when the suspension is being fully compressed or extended.

HOW TO INSTALL

