



Kit Contents

Description	Part No	Pcs
Shock absorber	BM503	1
C-spanner	00710-02	1
Sticker set Öhlins		1
Sticker Memo notes	01180-01	1
Owner's Manual	07241-02	1

Note!

Please note that this image is a general representation of the product and may differ slightly from your product.

Note!

Please note that during storage and transportation, especially at high ambient temperature, some of the oil and grease used for assembling may leak and stain the packaging. This is in no way detrimental to the product, wipe off the excessive oil/grease with a cloth.

Warning!

Before installing this product, read the Öhlins Owner's Manual. The shock absorber/front fork/steering damper is an important part of your vehicle and will affect the stability.

Shock absorber for BMW R 1200 RT, front

BM 503

Mounting Instructions

MOUNTING INSTRUCTIONS

⚠ Warning!

It is advisable to have an Öhlins dealer install the shock absorber/front fork/steering damper.

⚠ Warning!

If working on a raised vehicle, ensure it is securely supported so that it will not tip.

👁 Note!

Before mounting this product clean the vehicle thoroughly.

👁 Note!

When working on this product, always see the Vehicle Service Manual for vehicle specific procedures and important data.

1

Put the motorcycle on center stand.

2

Place a lift jack under the engine to raise and lower the motorcycle.

3

Remove the fuel tank lid. Remove the front side fairings below the mirrors. Remove the fuel tank covers and the combined tank and engine fairing.

👁 Note!

The screws holding the fairings are of different lengths. Make sure to reinstall them to the correct position.

4

Loosen the front brake tubing attachment. The screw is located between the pipes.

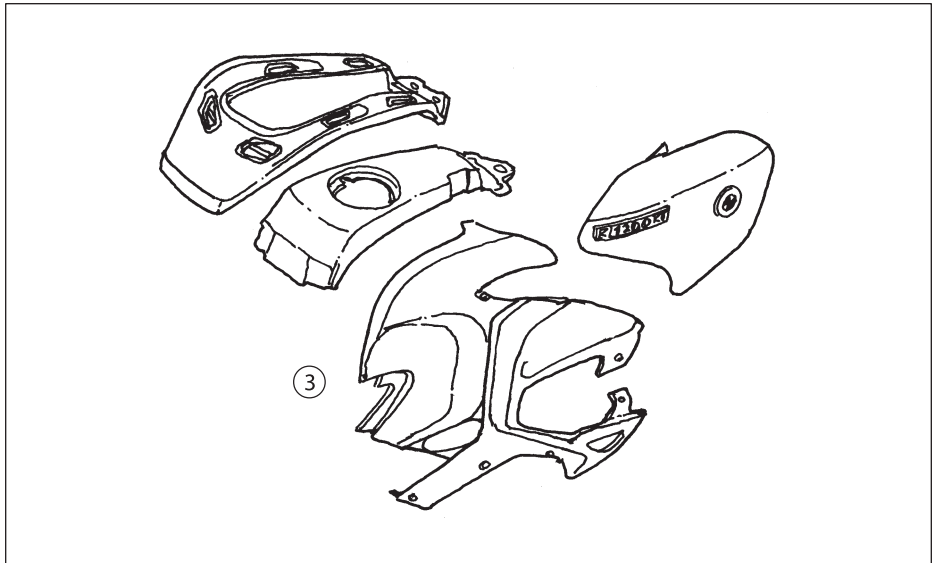
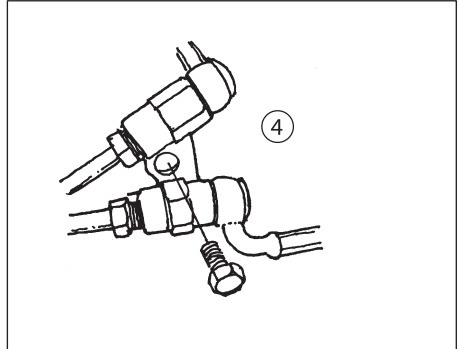

MOUNTING INSTRUCTIONS

Caution!

It is necessary to pull the front fork down to release the shock absorber. The brake hoses will restrict this movement. To avoid damages to the hoses be very careful not to pull hard.

5

If the shock absorber is equipped with ESA, disconnect the cables.

6

Loosen the upper attachment nut of the original shock absorber.

7

Raise the bike by assistance of the jack.

8

Loosen the lower attachment bolt.

9

Remove the original shock absorber forwards and slightly to the side.

10

Mount the Öhlins shock absorber in reverse order, first the lower attachment, then lower the bike and fit the upper attachment. Use the original rubber mounts and sleeve to the upper bracket.

Note!

Lower the vehicle so that the suspension is slightly compressed before tightening the screws.

11

Mount the brake tubing.

12

Refit the fairings, covers and fuel tank lid.

Caution!

Ensure that all screws are tightened to the correct torque and that nothing fouls or restricts movement of the shock absorber/front fork/steering damper when the suspension is fully compressed or extended.

ADJUSTMENTS

⚠ Warning!

Before riding, always make sure that the basic settings made by Öhlins are according to recommended Set-up Data. Read about adjustments and setting up in the Öhlins Owner's Manual before you make any adjustments. Contact an Öhlins dealer if you have any questions about setting up.

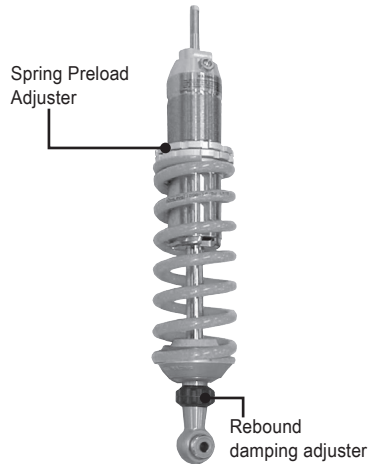

SET-UP DATA

Length	330	mm
Stroke	78	mm
Rebound	16	clicks
Spring preload	10	mm

👁 Öhlins products are subject to continuous improvement and development, therefore, although these instructions include the most up-to-date information available at the time of printing, minor updates may occur.

To find the latest information contact an Öhlins distributor. Please contact Öhlins if you have any questions regarding the contents in this document.

Part no. MI_BM503_1
Issued 2017-01-01



© Öhlins Racing AB. All rights reserved. Any reprinting or unauthorized use without the written permission of Öhlins Racing AB is prohibited.

Öhlins Racing AB
Box 722
S-194 27 Upplands Väsby, Sweden
Phone +46 8 590 025 00
fax +46 8 590 025 80



www.ohlins.com